



1A Series

Sealed Miniature Toggle Switches

IP 67
ACCORDING TO
EN 60529:1989+A1:2001
IEC 60529:2001

C US
E 187490

RoHS
compliant

Pb
lead-free

1A
Toggle Switches

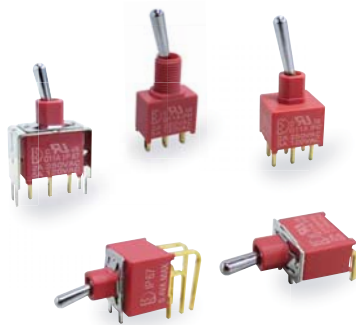

SPECIFICATIONS

CONTACT RATING: Dependent upon contact material, see page 17.

MECHANICAL LIFE: 30,000 make-and-break cycles.

CONTACT RESISTANCE: 10 mΩ max. (initial value) @ 2-4VDC
100mA for both silver and gold plated contacts.

INSULATION RESISTANCE: 1,000 MΩ min./1000VDC

DIELECTRIC STRENGTH: 1,000 Vrms min.@sea level.(initial value)

OPERATING TEMPERATURE: -40°C to 85°C.

MATERIALS

CASE & BUSHING: Glass filled nylon 6/6, flame retardant, heat stabilized (UL94v-0).

ACTUATOR: Brass with chrome plated, internal o-ring sealed.

SWITCH SUPPORT: Brass or steel, tin plated.

SWITCH SUPPORT RETAINER: Stainless steel.

CONTACT / TERMINALS: Copper with silver or gold plated.

(See page 17)

HOW TO ORDER

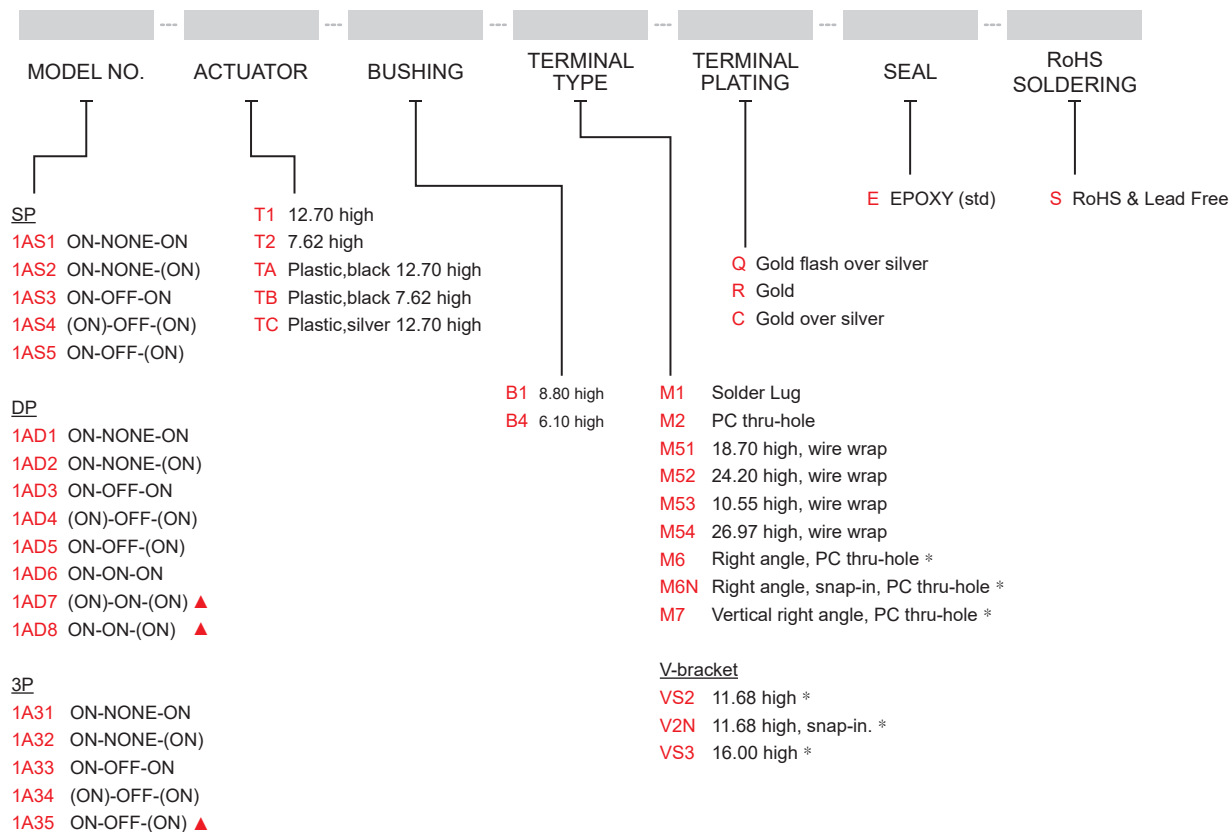

▲ Please confirm the availability before order.

* Only available for B4 bushing.

EXAMPLE: 1AS1T1B1M1QES



▼ SWITCH FUNCTION

NO. POLES	UL/CSA MODEL NO.	MODEL NO.	SWITCH FUNCTION			CONNECTED TERMINALS / SCHEMATIC		
			POS.1	POS.2	POS.3	POS.1	POS.2	POS.3
SP	Q11A11	1AS1	ON	NONE	ON		N/A	
	Q11A12	1AS2	ON	NONE	(ON)			
	Q11A13	1AS3	ON	OFF	ON			
	Q11A14	1AS4	(ON)	OFF	(ON)			
	Q11A15	1AS5	ON	OFF	(ON)			
DP	Q11A21	1AD1	ON	NONE	ON		N/A	
	Q11A22	1AD2	ON	NONE	(ON)			
	Q11A23	1AD3	ON	OFF	ON			
	Q11A24	1AD4	(ON)	OFF	(ON)			
	Q11A25	1AD5	ON	OFF	(ON)			
	▲ Q11A27	1AD7	(ON)	ON	(ON)			
	▲ Q11A28	1AD8	ON	ON	(ON)			
	3P	Q11A31	1A31	ON	NONE			
Q11A32		1A32	ON	NONE	(ON)			
Q11A33		1A33	ON	OFF	ON			
Q11A34		1A34	(ON)	OFF	(ON)			
▲ Q11A35		1A35	ON	OFF	(ON)			

() = MOMENTARY

▲ Please confirm the availability before order.

▼ POLE OPTIONS

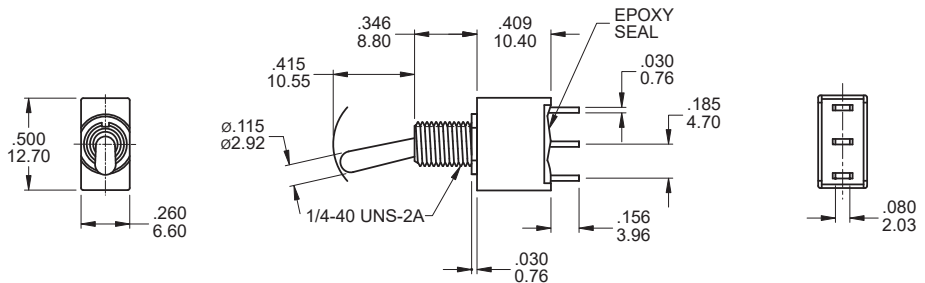

SPDT

Model name. 1AS1T1B1M1QES



1A Series

Sealed Miniature Toggle Switches

IP 67
ACCORDING TO
EN 60529:1989+A1:2001
IEC 60529:2001



1A
Toggle Switches

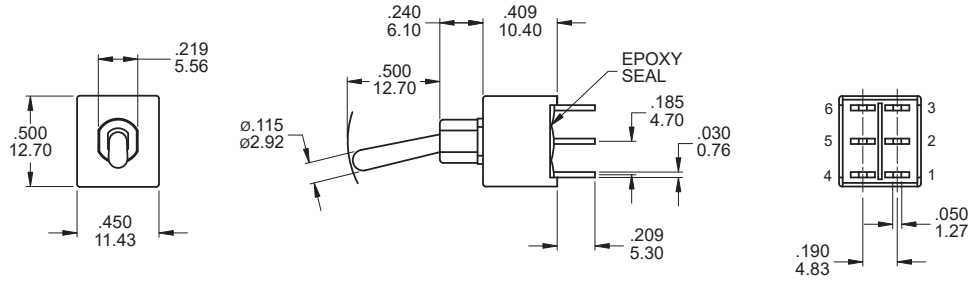

DPDT

Model name. 1AD1T1B4M2QES

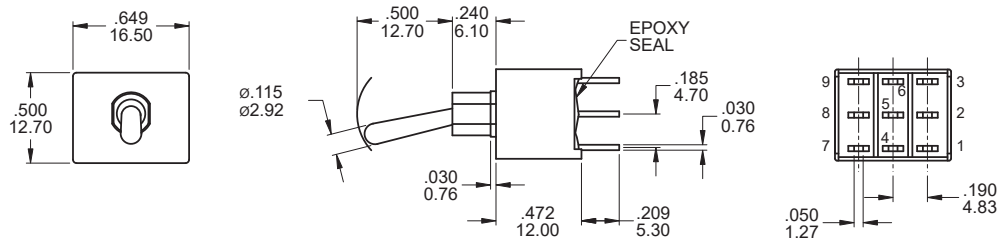

3PDT

Model name. 1A31T1B4M2QES

▼ ACTUATOR OPTIONS

Actuator are shown with Bushing B4(standard)
Note: For B1 Bushing: - .085inch(2.15mm)

T1

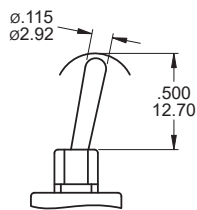

T2

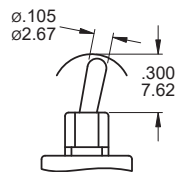

TA

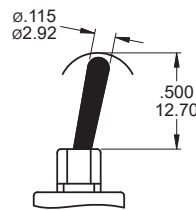

TB

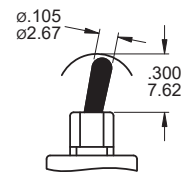

PLASTIC ACTUATOR
(TC, Silver)

▼ BUSHING OPTIONS

B1

Note: Standard for terminal M1.

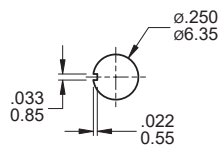
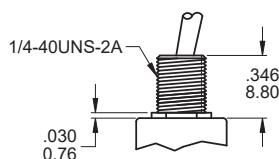

Without locking ring (Keyway)

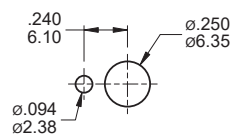

With standard locking ring.

B4

Note: Standard for terminal M2, M6, M7, VS.

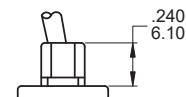



▼ **TERMINAL OPTIONS**

M1 Solder lug

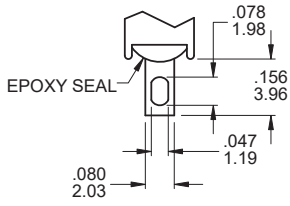

.030inch(0.76mm)THK

M2 PC Thru-hole

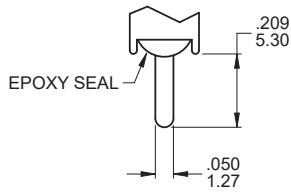

.030inch(0.76mm)THK

M3 Quick connect

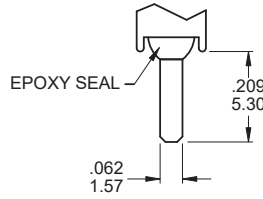

.030inch(0.76mm)THK

M5 Wire Wrap

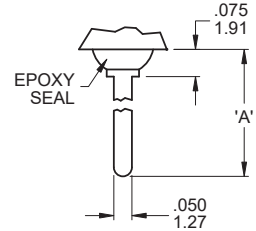

.030inch(0.76mm)THK

▼ **OTHER TERMINAL OPTIONS**

M6 Right angle P.C. Mount

M7 Vertical right angle P.C. Mount

VS2 Vertical bracket P.C. Mount

VS3 Vertical bracket P.C. Mount

M6N Right angle P.C. Mount
with snap-in bracket

V2N Vertical bracket P.C. Mount
with snap-in bracket

OPTION CODE	DIM. 'A'
M51	.736 (18.70)
M52	.953 (24.20)
M53	.415 (10.55)
M54	1.062 (26.97)

M6
(M6N - Snap-in)

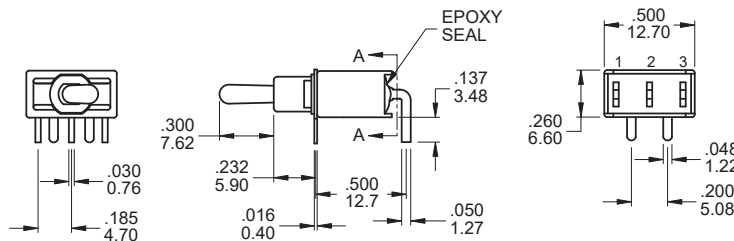

Section drawing for A-A.

PCB MOUNTING

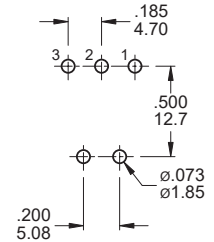

SPDT

Model name. 1AS1T2B4M6QES

M6

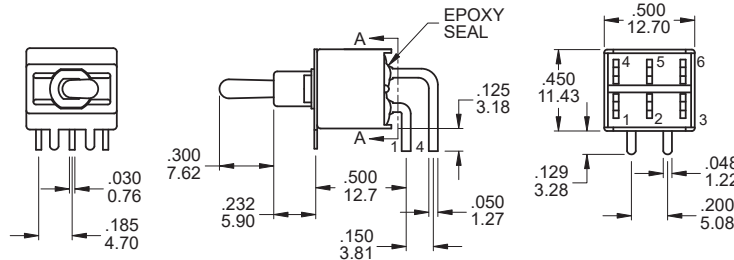

Section drawing for A-A.

PCB MOUNTING

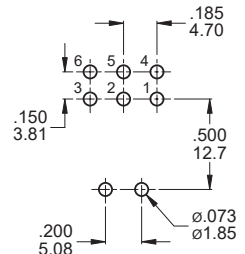

DPDT

Model name. 1AD1T2B4M6QES

M7

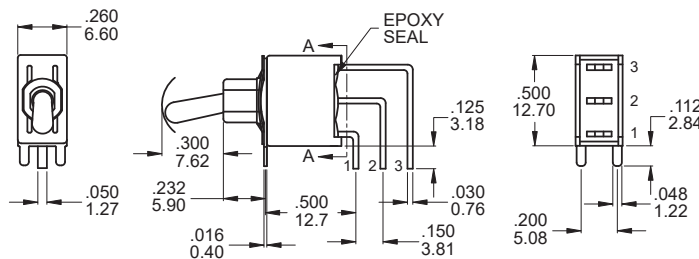

Section drawing for A-A.

PCB MOUNTING

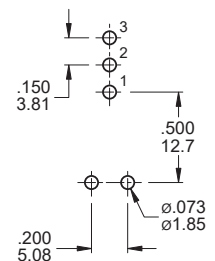

SPDT

Model name. 1AS1T2B4M7RES



1 A
Toggle Switches

M7

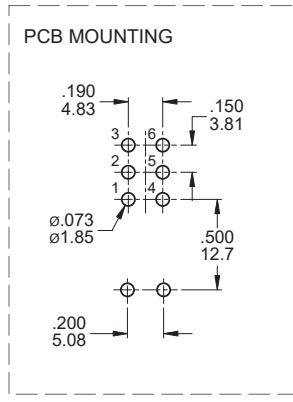
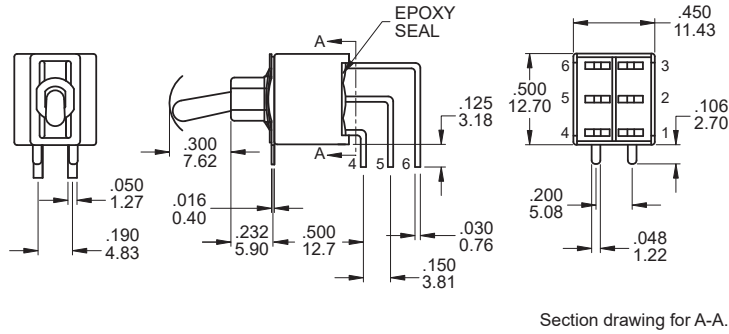

DPDT

Model name. 1AD1T2B4M7RES

M7

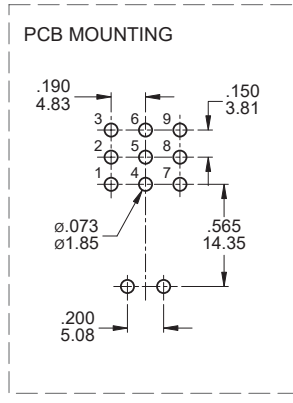
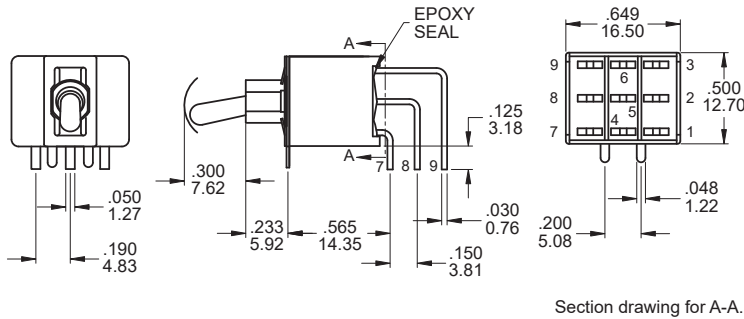

3PDT

Model name. 1A31T2B4M7QES

VS2 / VS3
(V2N - Snap-in)

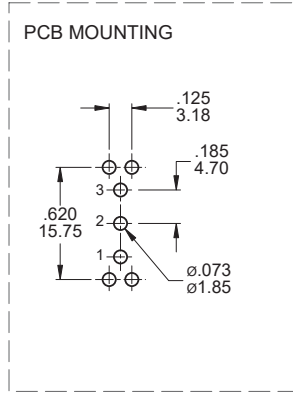
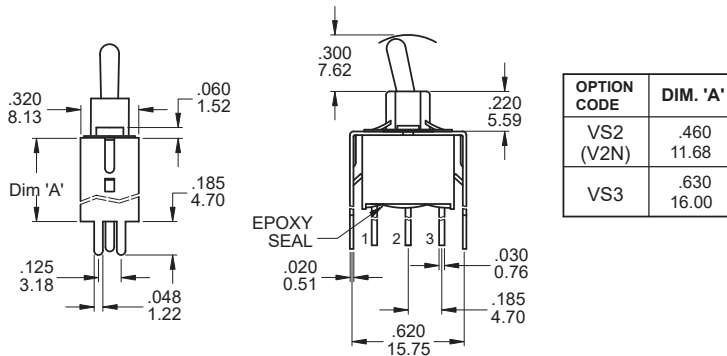

SPDT

Model name. 1AS1T2B4VS2QES

VS2 / VS3
(V2N - Snap-in)

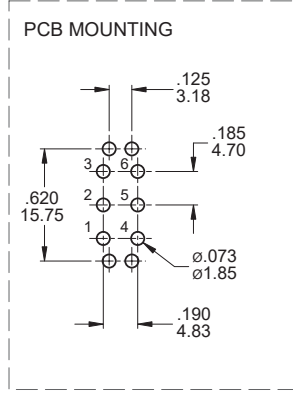
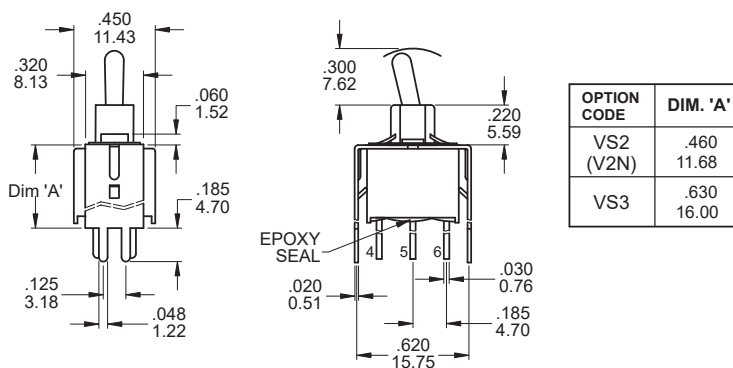

DPDT

Model name. 1AD1T2B4VS2QES



VS2 / VS3
(V2N - Snap-in)

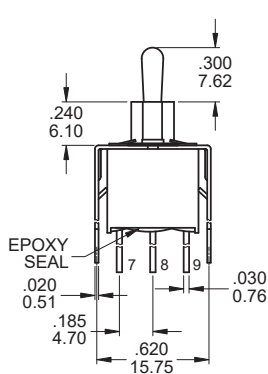
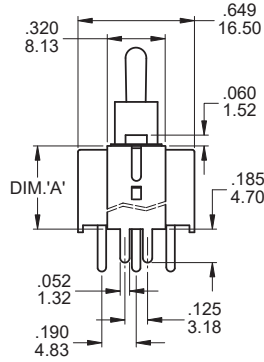

OPTION CODE	DIM. 'A'
VS2 (V2N)	.460 11.68
VS3	.630 16.00

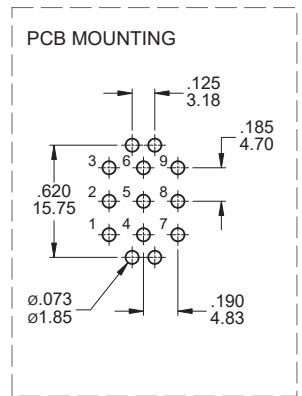

3PDT

Model name. 1A31T2B4VS2QES

▼ SNAP-IN TERMINAL OPTIONS

M6N

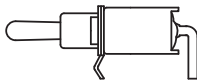

V2N

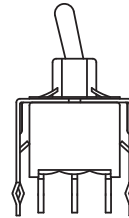

▼ HARDWARE

EXAMPLE: -
Model name. 5 Standard hardware

* Standard Hardware: 2 nut, 1 locking ring, 1 lockwasher

1/4 NUT (Std.)

Model name. MNU-1M01A

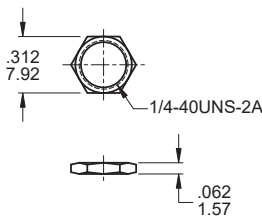

LOCKING RING (Std.)

Model name. MNU-1M02

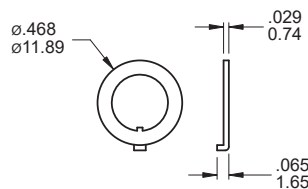

LOCKWASHER (Std.)

Model name. MNU-1M03

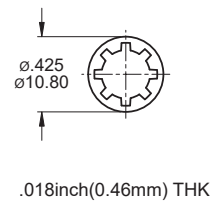

▼ CONTACT & TERMINAL PLATING OPTIONS

	CONTACT PLATING	TERMINAL PLATING	RATINGS
Q	Silver	Gold flash over silver	5 Amps with resistant load @ 120VAC or 28VDC 2 Amps with resistant load @ 250VAC
C	Gold over Silver	Gold over silver	
R	Gold	Gold	0.4 Volt - Amps (VA) max. @ 20V max. (AC or DC)

▼ SOLDERING PROCESS

MANUAL SOLDERING: Use 30 watts soldering iron and controlled the temperature at 350°.

Duration of solder immersion: Max. 5 sec.

WAVE SOLDERING: Recommend soldering temperature: 260 ± 5°C

Duration of solder immersion: Max. 5 sec. (PCB thickness is 1.6mm)